

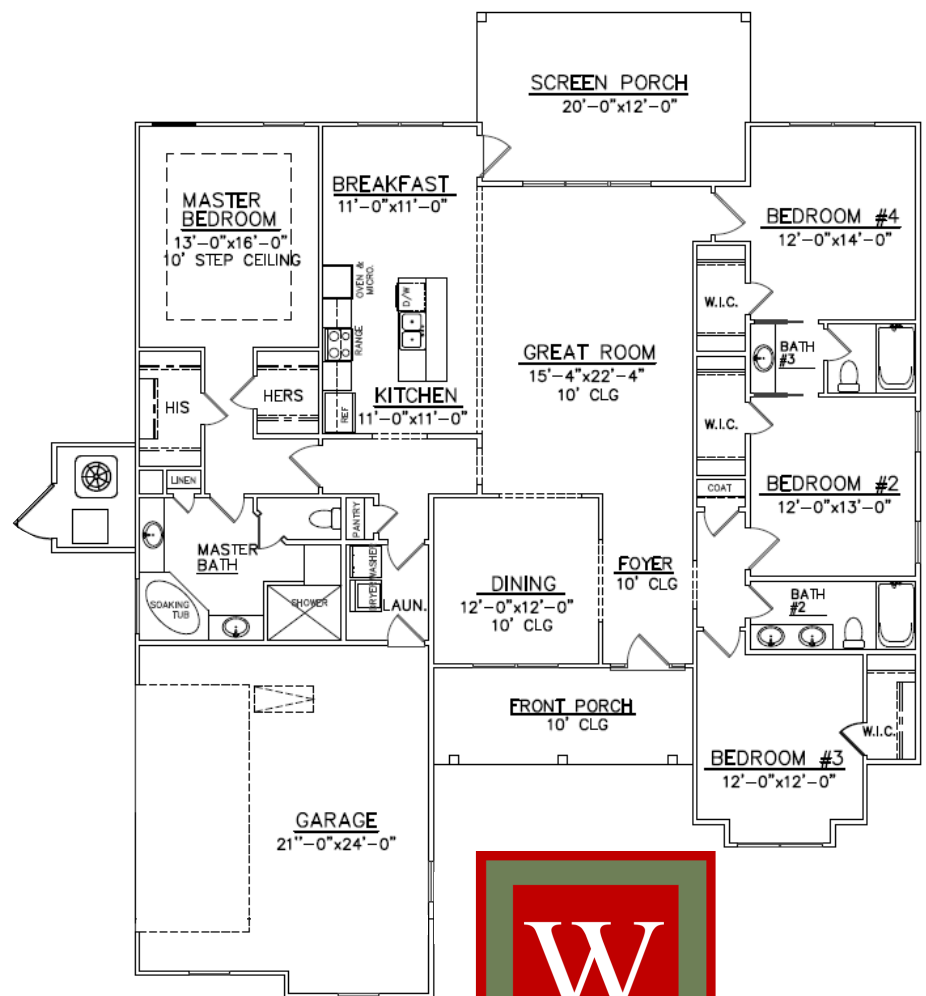

The 2326 Island Plan

Offered by *Josselyn Homes*

- Four bedroom, three bath
- 2,326 square feet, as per builder's plans
- Granite countertops
- PEX plumbing system
- 9 ft.+ ceilings
- Custom maple cabinetry
- Stainless steel appliances package
- Limestone tile shower and floors
- Maintenance-free stucco siding



Construction by Josselyn Homes Inc.

W.E. Josselyn III
 C: 912.222.5595
 Joss@JosselynHomes.com

P.O. Box 5793
 St. Mary's, Georgia 31558

Owner is a licensed Realtor



We can build in your neighborhood or ours. Ask us about our many floor plans or visit JosselynHomes.com for more information.

Voted Camden County's Best Builder/Contractor for 2013 and 2014.

